

LED FLAT PANEL FIXTURE INSTRUCTIONS

CAUTION

TURN OFF THE MAIN POWER AT THE CIRCUIT BREAKER BEFORE INSTALLING THE FIXTURE, IN ORDER TO PREVENT POSSIBLE SHOCK.



GENERAL

All electrical connections must be in accordance with local and National Electrical Code (N.E.C.) standards. If you are unfamiliar with proper electrical wiring connections obtain the services of a qualified electrician.

Remove the fixture and the mounting package from the box and make sure that no parts are missing by referencing the illustrations on the installation instructions.

THIS PRODUCT MUST BE INSTALLED IN ACCORDANCE WITH THE APPLICABLE INSTALLATION CODE BY A PERSON FAMILIAR WITH THE CONSTRUCTION AND OPERATION OF THE PRODUCT AND THE HAZARDS INVOLVED.

THIS FLAT PANEL REQUIRES TWO PEOPLE TO INSTALL.

MOUNTING INSTRUCTIONS

READ IMPORTANT SAFETY INFORMATION FIRST ON REVERSE SIDE OF THIS SHEET

PARTS INCLUDED:	QTY
1. Mounting Plate (11.02" x 10.94" x .47")	1
2. 3/16 in. Toggle Bolt	6
3. Wire Nuts	3
4. Screws #8-32 x1	2
5. Quick Connect Jumper – black/white	1
6. Quick Connect Jumper – green	1

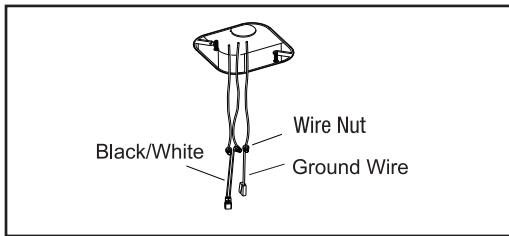

Step 1

- Connect Quick Connect Assembly (5) to building supply wires using provided wire nuts (3):
 - Connect the black wire to the building line voltage
 - Connect the white wire to the building common
- Connect Quick Connect Assembly (6) to the building ground using provided wire nut (3):
 - Connect the green/yellow striped wire to the building ground

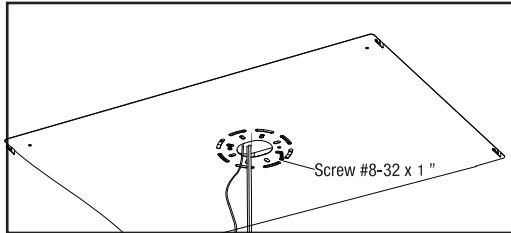

Step 2

- Install the mounting plate (1) to the junction using the two #8-32 x 1 in. screws (4) provided
- Align the mount plate in the direction you want the fixture to be aligned

NOTE: Once the anchor bolts are installed, you cannot change the orientation of the LED Flat Panel. Take care to align the mount plate properly in this step

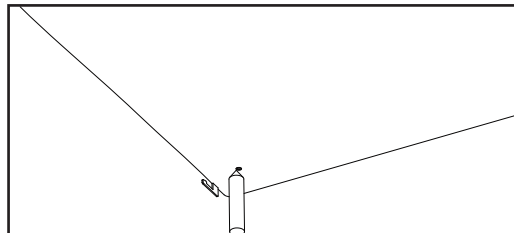

Step 3

- Mark the position of the six holes on the ceiling or wall where the anchors will be placed

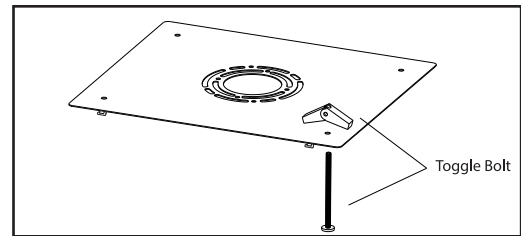

Step 4

- Remove the mounting plate (1) from the junction box and discard the two #8 screws (4)
- Drill the marked holes using a 1/2 in. drill bit
- Remove the wings from the 3/16 in. anchor bolts (2)
- Insert screw (2) through front of mount plate (1) and then reattach the wing to the screw, do this for all six anchor bolts

NOTE: Take care to re-install the wing in the same orientation as the image shown. If this is not done, the luminaire will not be properly secured and could fall resulting in serious injury.

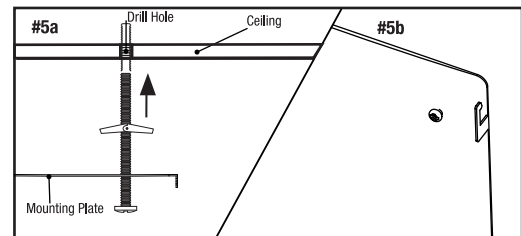

Step 5

- Re-install the mounting plate onto the ceiling by inserting the six anchor bolts into the drilled holes
- Once the wings are through the drywall and have expanded, pull the screw downward to engage the wing on the backside of the ceiling. Once engaged, secure into place by tightening the screws

NOTE: When installing the LED Flat Panel on a vertical surface, the mounting plate must be installed in such a way that the mounting tabs are oriented in a vertical position as shown in Fig #5B. If the mounting tabs are not oriented vertically, the luminaire will not be properly secured and could fall resulting in serious injury.

LED FLAT PANEL FIXTURE INSTRUCTIONS

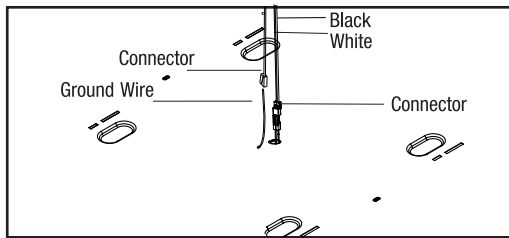

Step 6

Connecting the LED Flat Panel

- Snap together the Quick Connect Assembly (5) and (6) to their respective connectors
- When installing the LED Flat Panel into place, push all excess wires back into the junction box

NOTE: Care must be taken not to have excess wires outside the junction box to avoid pinching wires. This may cause a short and could lead to a potential hazard.

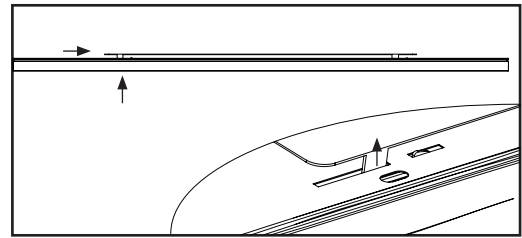

Step 7

- Install the LED Flat Panel to the mounting plate by aligning the mounting tabs to the slots in back of the panel using the arrow labels on the side of the panel as a guide
- Slide and lock the panel into place
- Remove arrow labels once the panel is locked into place

IMPORTANT SAFETY INFORMATION

1. **WARNING: RISK OF SHOCK** House electric current can cause painful shock or serious injury unless handled properly. For your safety, always remember to:
 - A. Turn off the power supply at the fuse or circuit breaker box before you install the fixture.
 - B. Ground the fixture to avoid potential electric shocks and to ensure reliable starting.
 - C. Double-check all connections to be sure they are tight and correct.
 - D. Wear rubber soled shoes and work on a sturdy wooden ladder.
2. This fixture is designed for use in a circuit protected by a fuse or circuit breaker. It is also designed to be installed in accordance with local electrical codes. If you are unsure about your wiring, consult a qualified electrician or local electrical inspector, and check your local electrical code.
3. **WARNING: RISK OF CUTS** Some metal parts in the fixture may have sharp edges. To prevent cuts and scrapes, wear gloves when handling the parts.
4. Account for small parts and destroy packing material, as these may be hazardous to children.

LIMITED WARRANTY

This product is warranted to be free from defects in workmanship and materials for up to 5 years from date of purchase. If it fails to do so, please contact Feit Electric at info@feit.com or call 1-866 326-BULB (2852) for instructions on replacement. Do not return the product to the store.

For comments please write to:
 FEIT ELECTRIC
 Customer Service Department
 4901 Gregg Road, Pico Rivera, CA 90660

CAUTION

WARNING: Risk of fire. Use only on 120 volt 60Hz circuits. Suitable for damp locations. Before installing your lighting fixture, thoroughly review enclosed installation manual. If you do not have sufficient electrical wiring experience, please refer to a do-it-yourself wiring handbook or have your fixture installed by a qualified licensed electrician. All electrical connections must be in accordance with Local and National Electrical Code (NEC) Standards. Reliable operating temperature is 0°F –120°F. If flickering occurs in low level dimming, increase light level. Compatible with most dimmers including Leviton 6681-IW, Lutron S-600P and Lutron DVCL-153. Dimmable to 10% with most dimmers. For more information including dimmer compatibility visit www.feit.com or call our toll free number 1-866-326-BULB.

This device complies with part 15 of the FCC Rules. Operation is subject to the following two conditions:
 (1) This device may not cause harmful interference, and
 (2) this device must accept any interference received, including interference that may cause undesired operation.
Note: This equipment has been tested and found to comply with the limits for a Class B digital device, pursuant to part 15 of the FCC Rules. These limits are designed to provide reasonable protection against harmful interference in a residential installation. This equipment generates, uses and can radiate radio frequency energy and, if not installed and used in accordance with the instructions, may cause

harmful interference to radio communications. However, there is no guarantee that interference will not occur in a particular installation. If this equipment does cause harmful interference to radio or television reception, which can be determined by turning the equipment off and on, the user is encouraged to try to correct the interference by one or more of the following measures: Reorient or relocate the receiving antenna. Increase the separation between the equipment and receiver. Connect the equipment into an outlet on a circuit different from that to which the receiver is connected. Consult the dealer or an experienced radio/TV technician for help.

SAVE THESE INSTRUCTIONS.