



WHS G2-UNV-T8-IS

Instant Start Fluorescent Ballast

- Solid State Electronic Ballast
- Universal Voltage: 120-277VAC ±10%, 50/60Hz
- Instant Start
- UL / cUL Listed, Class P

This Ballast Will Operate The Following Lamps:



F17T8 / F25T8 / F32T8 / FBO31T8 / F40T8
F32T8/30W, F32T8/28W, F32T8/25W

General Specifications

| | |
|----------------------|--|
| Input Voltage | 120 - 277VAC ±10%, 50 / 60Hz |
| Lamps Operated | 1 or 2 Lamps |
| EMI / RFI Compliance | FCC Part 18-A (Non-Consumer) |
| Sound Rating | " A " |
| Ballast Type | Instant Start |
| Voltage Transients | ANSI C82.11 - 1993 |
| Input Protection | Fuse |
| Min. Operating Temp | -18°C (0°F) |
| Max. Case Temp | 70°C (158°F) |
| Type "HL" Approval | Approved For Hazardous Location |
| Approvals Class | UL / cUL Listed, Class "P", 1 Outdoor |
| Warranty | 5 Years from the date of manufacture when properly installed |

Electrical Data @120VAC

| Lamp Wattage / Type | Lamps Operated | Input Wattage | Line Current | Power Factor | Ballast Factor | Efficacy Factor | THD |
|---------------------|----------------|---------------|--------------|--------------|----------------|-----------------|-------|
| F17T8 | 1 | 22.97 | 0.194 | 0.99 | 0.95 | 4.12 | 10.1% |
| F25T8 | 1 | 28.84 | 0.242 | 0.99 | 1.03 | 3.56 | 9.7% |
| F32T8 | 1 | 36.96 | 0.310 | 0.99 | 1.01 | 2.72 | 7.6% |
| F40T8 | 1 | 46.59 | 0.390 | 0.99 | 1.06 | 2.27 | 7.0% |
| FBO31T8 | 1 | 35.46 | 0.297 | 0.99 | 1.03 | 2.90 | 8.5% |
| F32T8/30 | 1 | 34.11 | 0.286 | 0.99 | 1.02 | 2.98 | 8.2% |
| F32T8/28 | 1 | 30.47 | 0.255 | 0.99 | 0.96 | 3.16 | 8.8% |
| F32T8/25 | 1 | 30.04 | 0.252 | 0.99 | 0.98 | 3.25 | 8.6% |
| F17T8 | 2 | 33.52 | 0.281 | 0.99 | 0.95 | 2.84 | 8.8% |
| F25T8 | 2 | 46.33 | 0.388 | 0.99 | 0.91 | 1.96 | 7.2% |
| F32T8 | 2 | 60.33 | 0.504 | 0.99 | 0.90 | 1.50 | 6.1% |
| FBO31T8 | 2 | 58.17 | 0.487 | 0.99 | 0.91 | 1.56 | 7.1% |
| F32T8/30 | 2 | 56.65 | 0.474 | 0.99 | 0.90 | 1.60 | 6.2% |
| F32T8/28 | 2 | 50.19 | 0.420 | 0.99 | 0.86 | 1.71 | 6.7% |
| F32T8/25 | 2 | 47.25 | 0.395 | 0.99 | 0.95 | 2.01 | 6.8% |

Electrical Data @230VAC

| Lamp Wattage / Type | Lamps Operated | Input Wattage | Line Current | Power Factor | Ballast Factor | Efficacy Factor | THD |
|---------------------|----------------|---------------|--------------|--------------|----------------|-----------------|------|
| F17T8 | 1 | 22.26 | 0.101 | 0.96 | 1.12 | 5.01 | 9.3% |
| F25T8 | 1 | 30.11 | 0.134 | 0.98 | 1.12 | 3.71 | 7.8% |
| F32T8 | 1 | 36.53 | 0.161 | 0.98 | 1.06 | 2.89 | 7.0% |
| F40T8 | 1 | 43.24 | 0.190 | 0.99 | 1.04 | 2.40 | 6.4% |
| FBO31T8 | 1 | 35.23 | 0.156 | 0.98 | 1.05 | 2.99 | 7.1% |
| F32T8/30 | 1 | 34.14 | 0.151 | 0.98 | 1.04 | 3.06 | 7.5% |
| F32T8/28 | 1 | 31.11 | 0.138 | 0.98 | 1.02 | 3.27 | 7.7% |
| F32T8/25 | 1 | 28.42 | 0.127 | 0.98 | 1.04 | 3.67 | 7.7% |
| F17T8 | 2 | 34.27 | 0.152 | 0.98 | 0.98 | 2.86 | 7.4% |
| F25T8 | 2 | 47.65 | 0.209 | 0.99 | 0.96 | 2.01 | 6.3% |
| F32T8 | 2 | 60.48 | 0.265 | 0.99 | 0.89 | 1.48 | 6.5% |
| FBO31T8 | 2 | 56.45 | 0.248 | 0.99 | 0.92 | 1.62 | 7.3% |
| F32T8/30 | 2 | 54.28 | 0.238 | 0.99 | 0.91 | 1.67 | 6.7% |
| F32T8/28 | 2 | 50.24 | 0.221 | 0.99 | 0.89 | 1.76 | 6.2% |
| F32T8/25 | 2 | 47.03 | 0.207 | 0.99 | 0.95 | 2.03 | 6.3% |

WHS2-UNV-T8-IS

Electrical Data @277VAC

| Lamp Wattage / Type | Lamps Operated | Input Wattage | Line Current | Power Factor | Ballast Factor | Efficacy Factor | THD |
|---------------------|----------------|---------------|--------------|--------------|----------------|-----------------|-------|
| F17T8 | 1 | 23.24 | 0.091 | 0.92 | 0.95 | 4.08 | 14.6% |
| F25T8 | 1 | 28.79 | 0.110 | 0.94 | 1.03 | 3.57 | 12.2% |
| F32T8 | 1 | 36.52 | 0.136 | 0.97 | 1.05 | 2.31 | 6.2% |
| F40T8 | 1 | 45.40 | 0.168 | 0.97 | 1.05 | 2.31 | 6.2% |
| FBO31T8 | 1 | 34.97 | 0.130 | 0.97 | 1.03 | 2.93 | 9.5% |
| F32T8/30 | 1 | 34.24 | 0.128 | 0.96 | 1.03 | 3.02 | 8.4% |
| F32T8/28 | 1 | 30.60 | 0.115 | 0.96 | 0.98 | 3.19 | 10.4% |
| F32T8/25 | 1 | 30.61 | 0.116 | 0.95 | 1.01 | 3.29 | 10.2% |
| F17T8 | 2 | 33.27 | 0.124 | 0.96 | 0.96 | 2.88 | 10.0% |
| F25T8 | 2 | 45.47 | 0.168 | 0.97 | 0.91 | 2.01 | 6.3% |
| F32T8 | 2 | 58.43 | 0.214 | 0.99 | 0.90 | 1.55 | 6.0% |
| FBO31T8 | 2 | 56.33 | 0.206 | 0.99 | 0.91 | 1.62 | 5.6% |
| F32T8/30 | 2 | 55.11 | 0.202 | 0.98 | 0.91 | 1.64 | 5.9% |
| F32T8/28 | 2 | 49.29 | 0.181 | 0.98 | 0.86 | 1.74 | 6.0% |
| F32T8/25 | 2 | 45.08 | 0.166 | 0.98 | 0.91 | 2.03 | 6.1% |

Mechanical Data

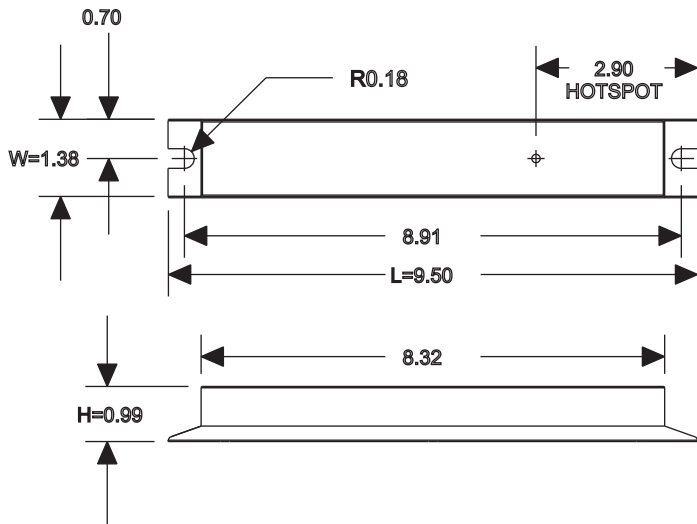

Where : L = Length, W = Width, H = Height

Wiring Diagram

| Wire Color | Length (Inches) | Wire Color | Length (Inches) |
|------------|-----------------|------------|-----------------|
| Black | 24" ±1" | Red | 46" ±1" |
| White | 24" ±1" | Blue | 32" ±1" |

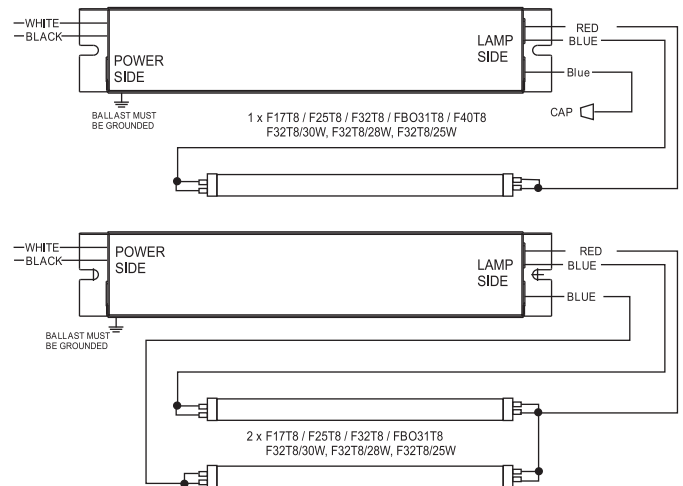

Note: This ballast case must be grounded